

**CHRISTCHURCH CATHEDRAL**  
**MAXIMUM RETENTION OPTION**  
**STAGE 1**

Form level access platform into west side of the cathedral

De-construct west porch & west nave wall

Relocate existing west bracing frame to southern side If required

Existing concrete shearwall strengthening

Relocate existing west bracing frame to southern side If required

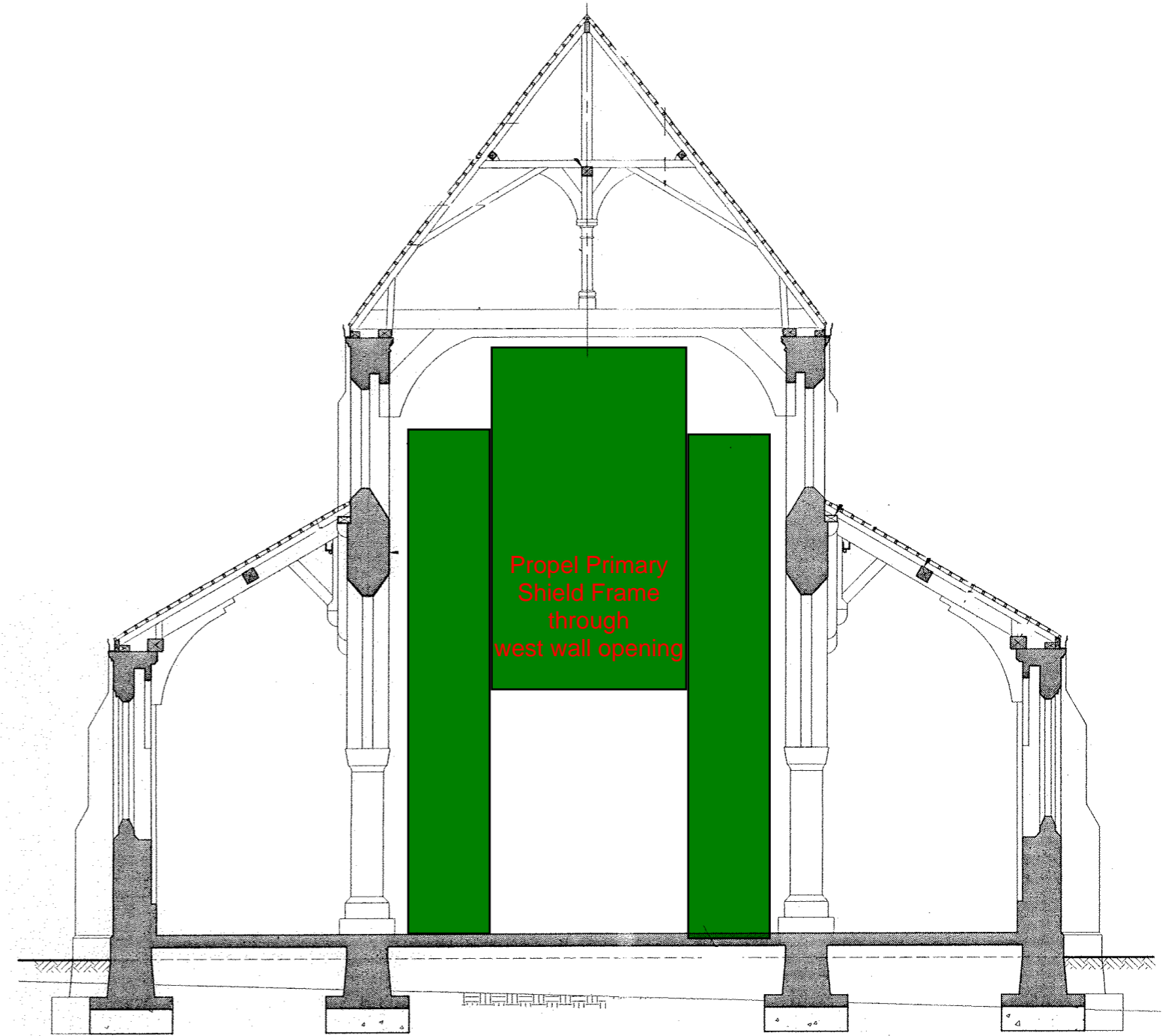
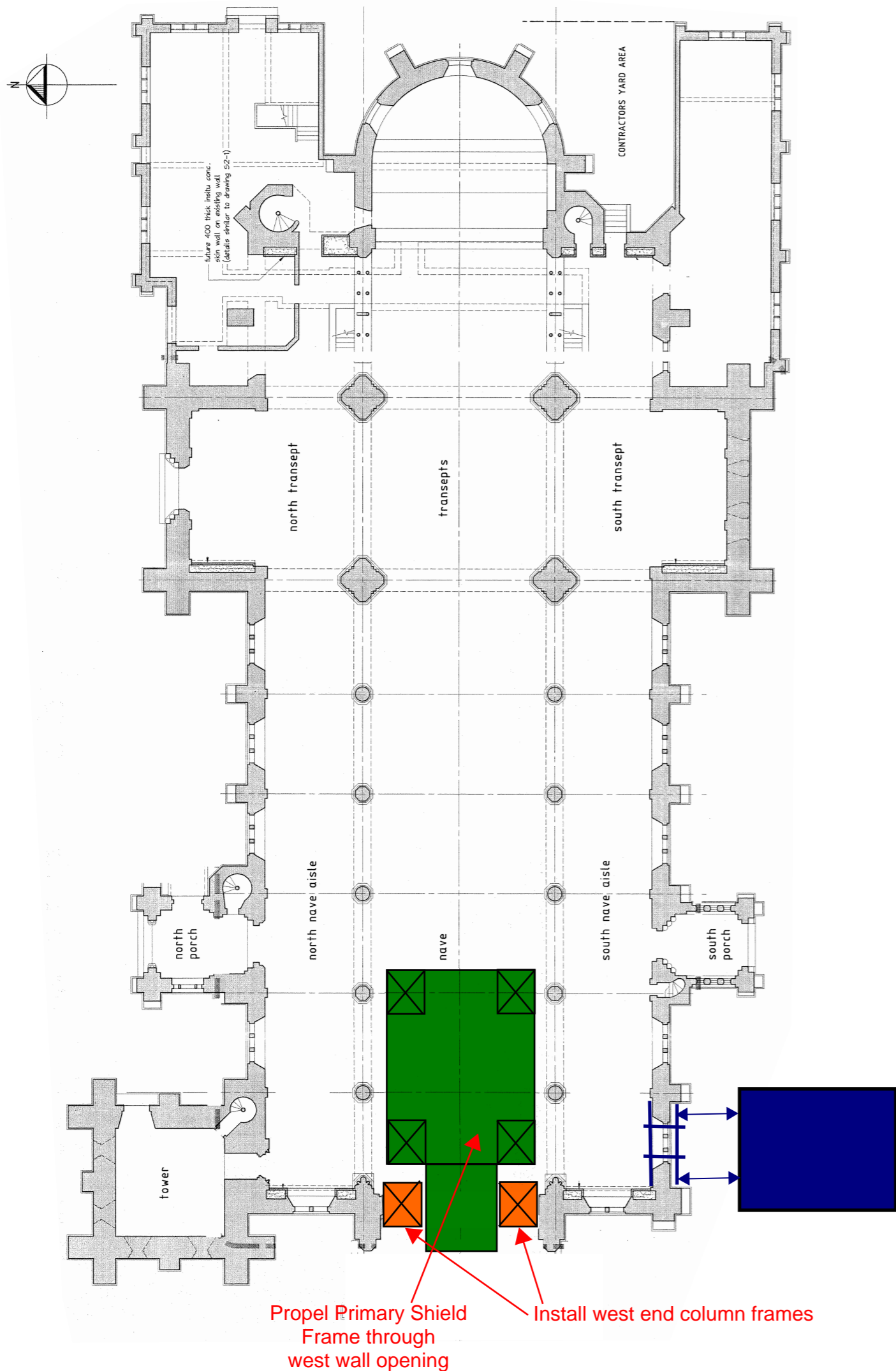

**CHRISTCHURCH CATHEDRAL**  
 MAXIMUM RETENTION OPTION  
 STAGE 2

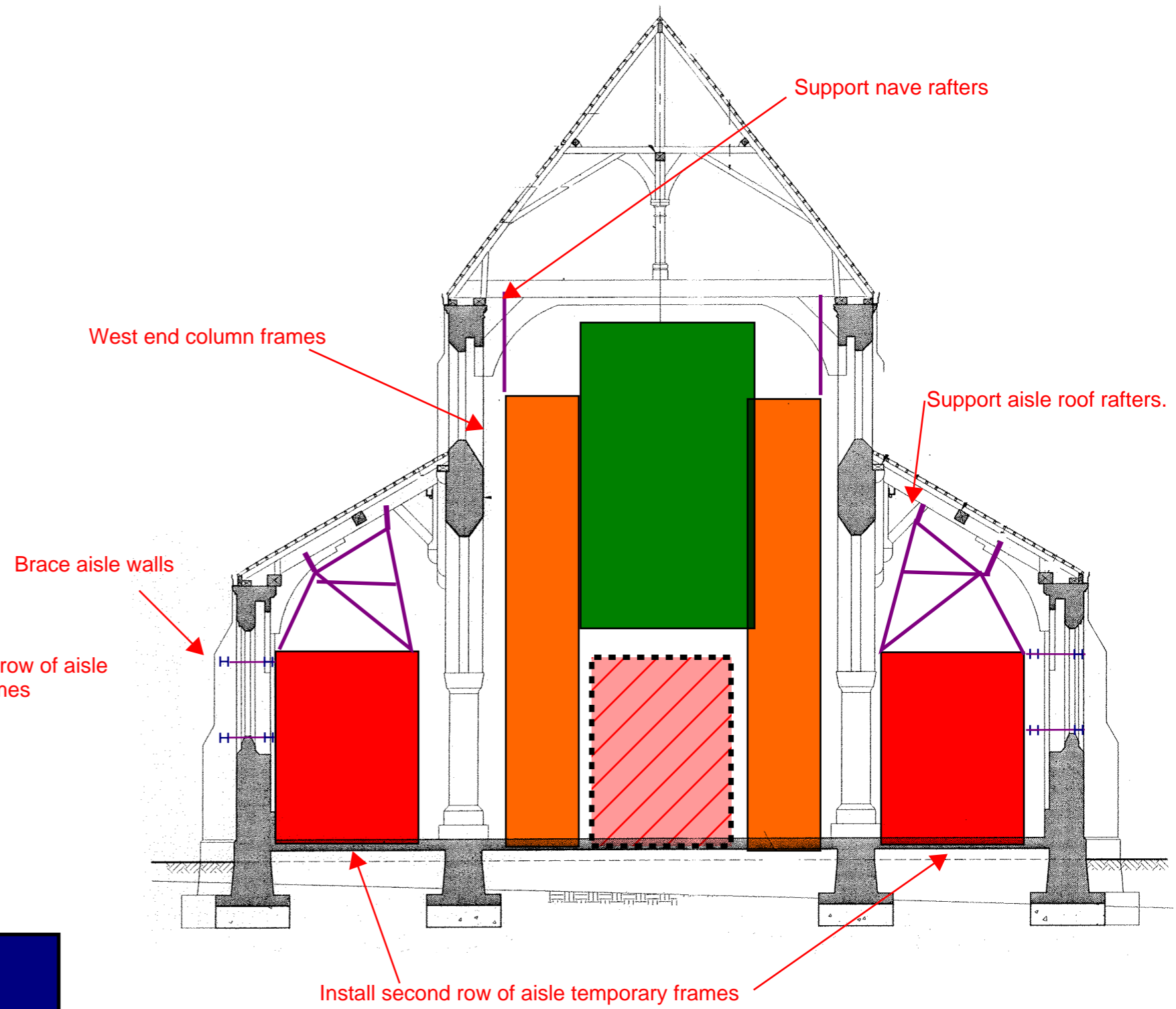
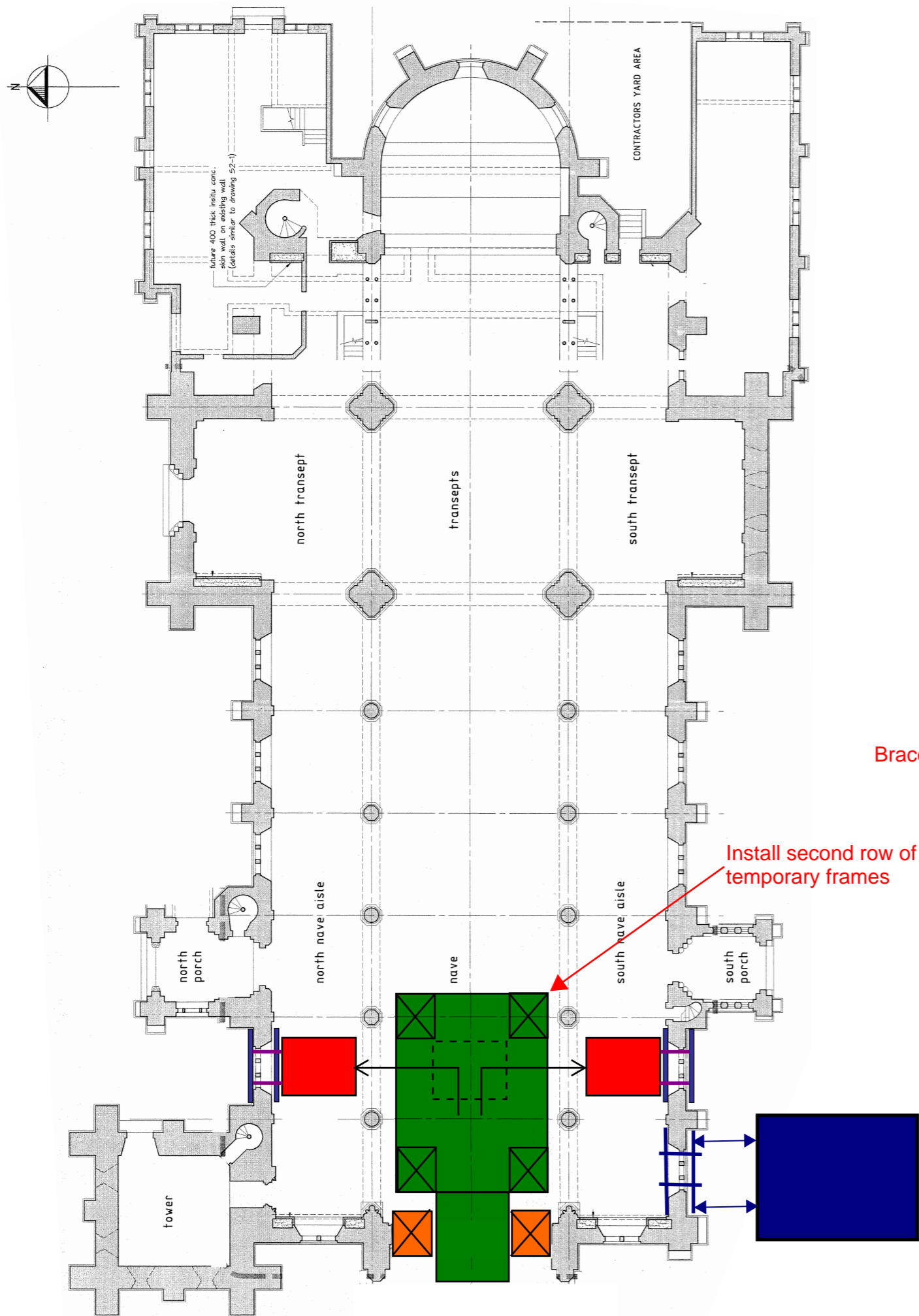

**CHRISTCHURCH CATHEDRAL**  
 MAXIMUM RETENTION OPTION  
 STAGE 3

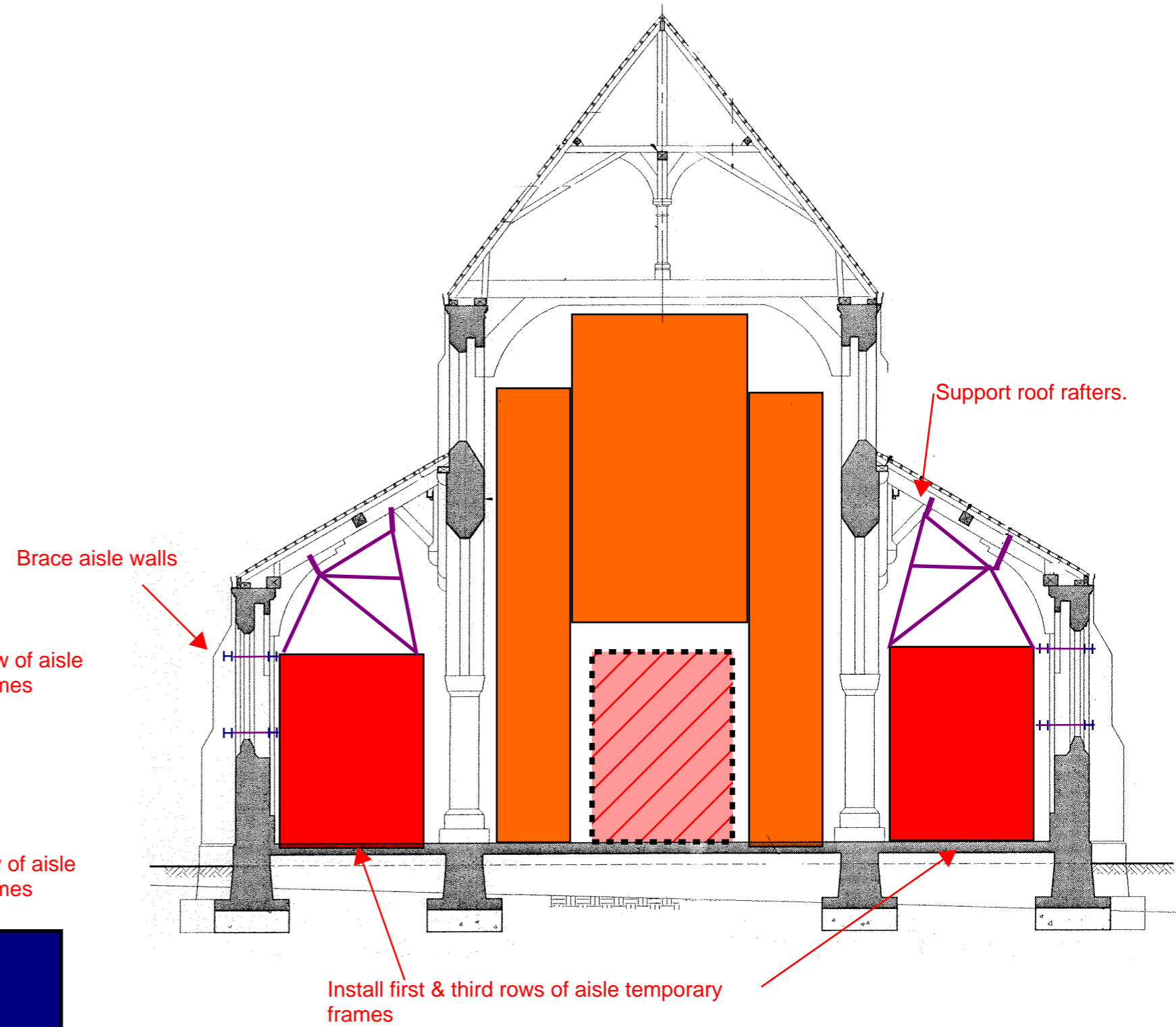
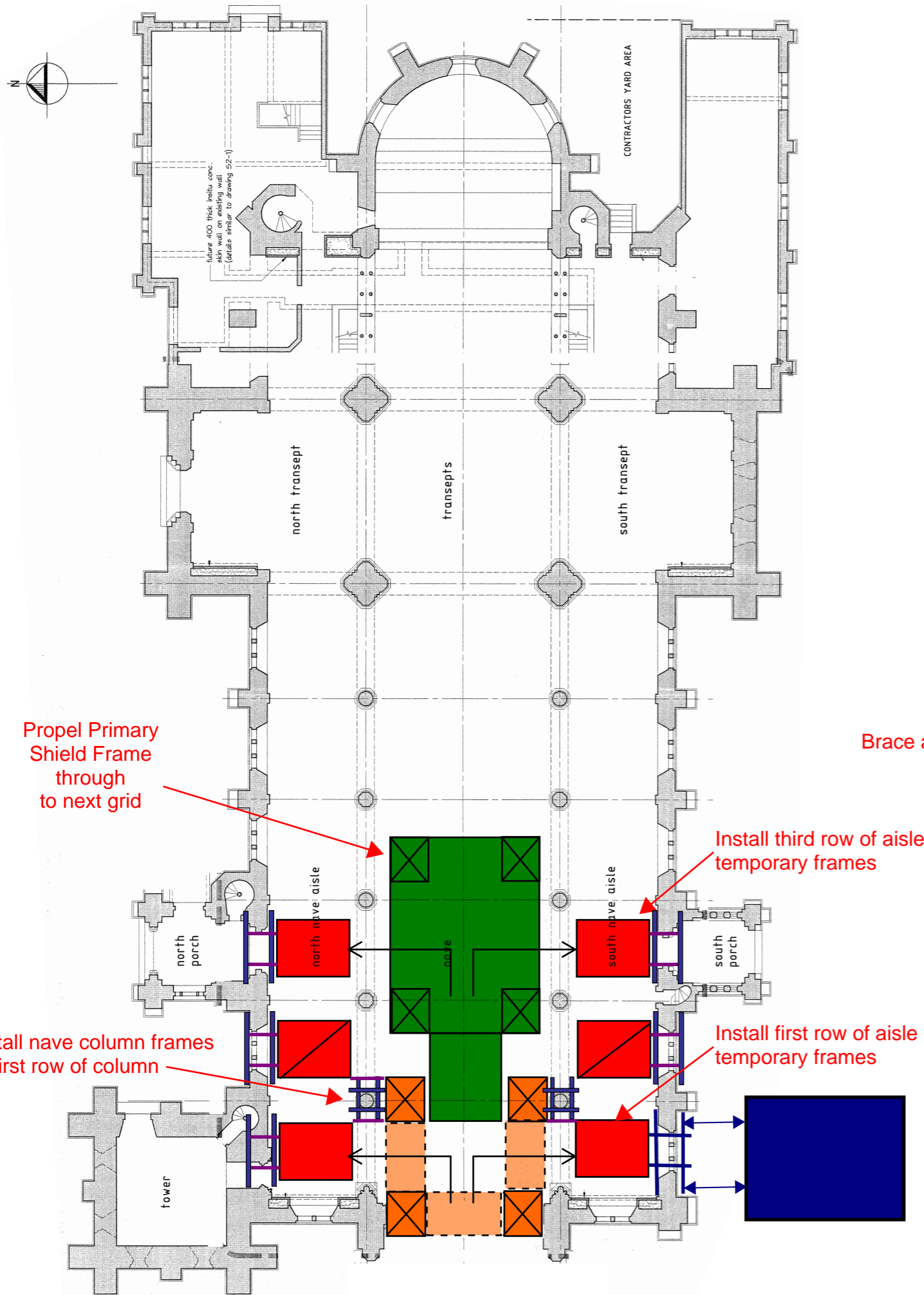

**CHRISTCHURCH CATHEDRAL**  
**MAXIMUM RETENTION OPTION**  
**STAGE 4**

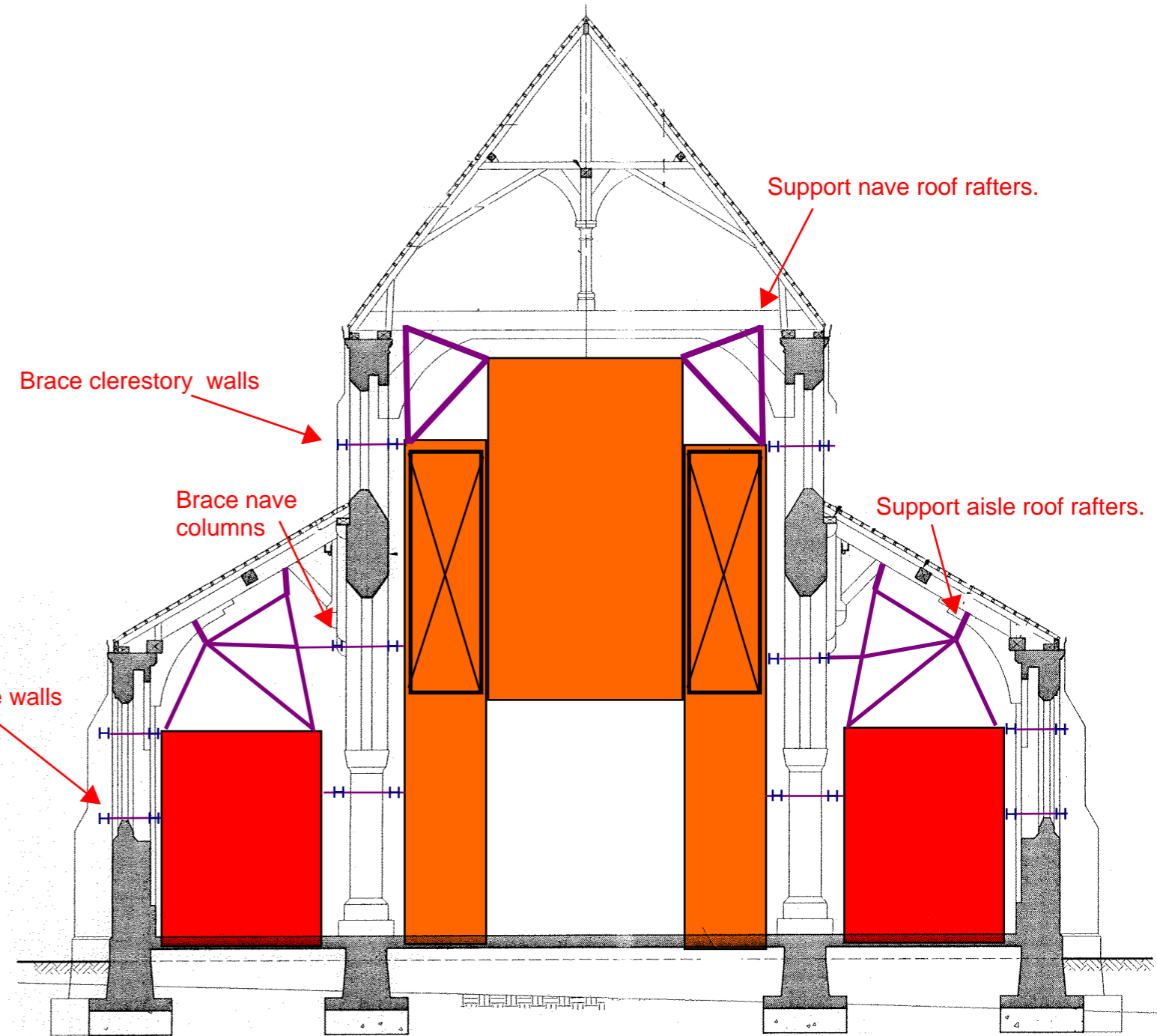
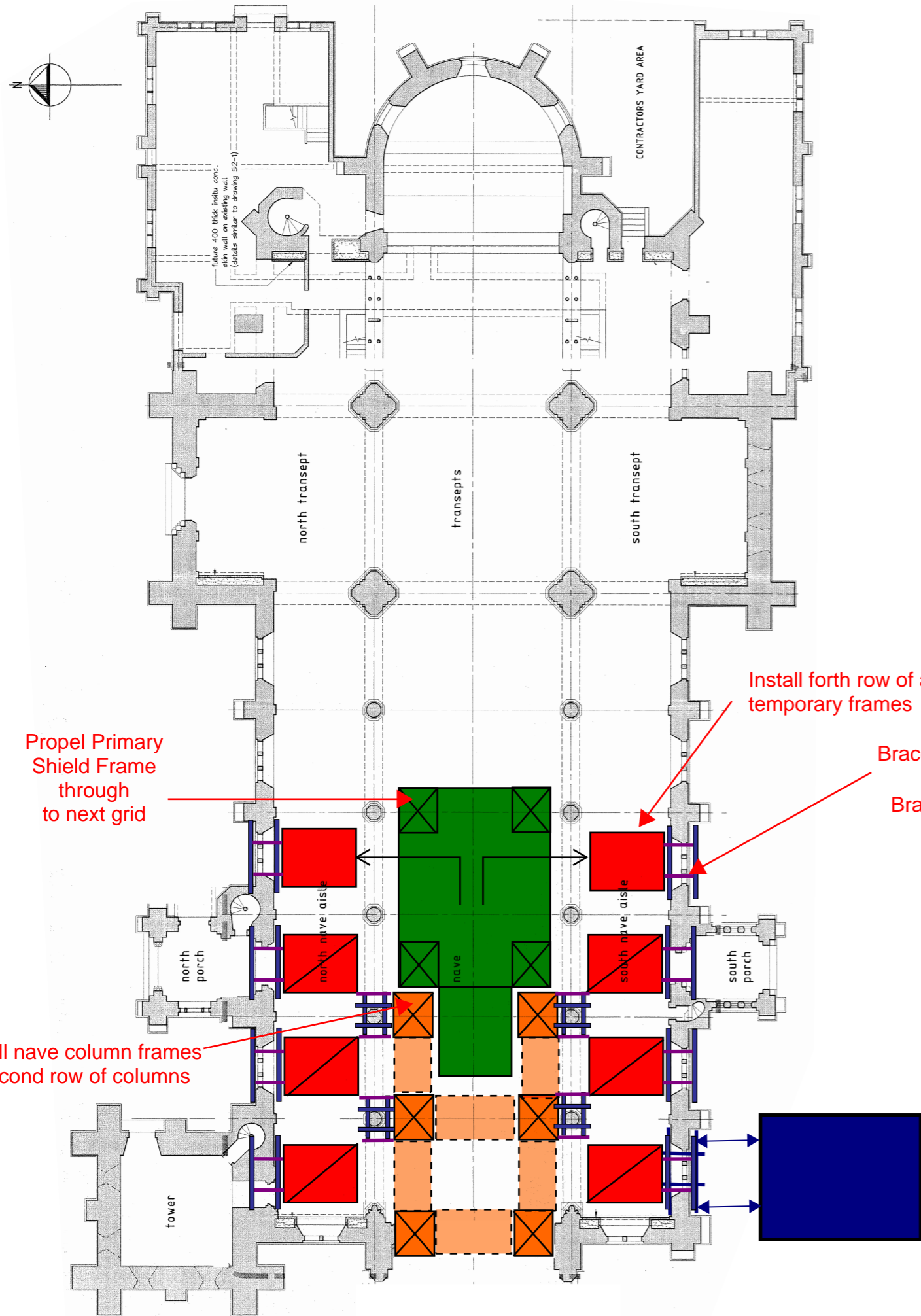

**CHRISTCHURCH CATHEDRAL**  
 MAXIMUM RETENTION OPTION  
 STAGE 5

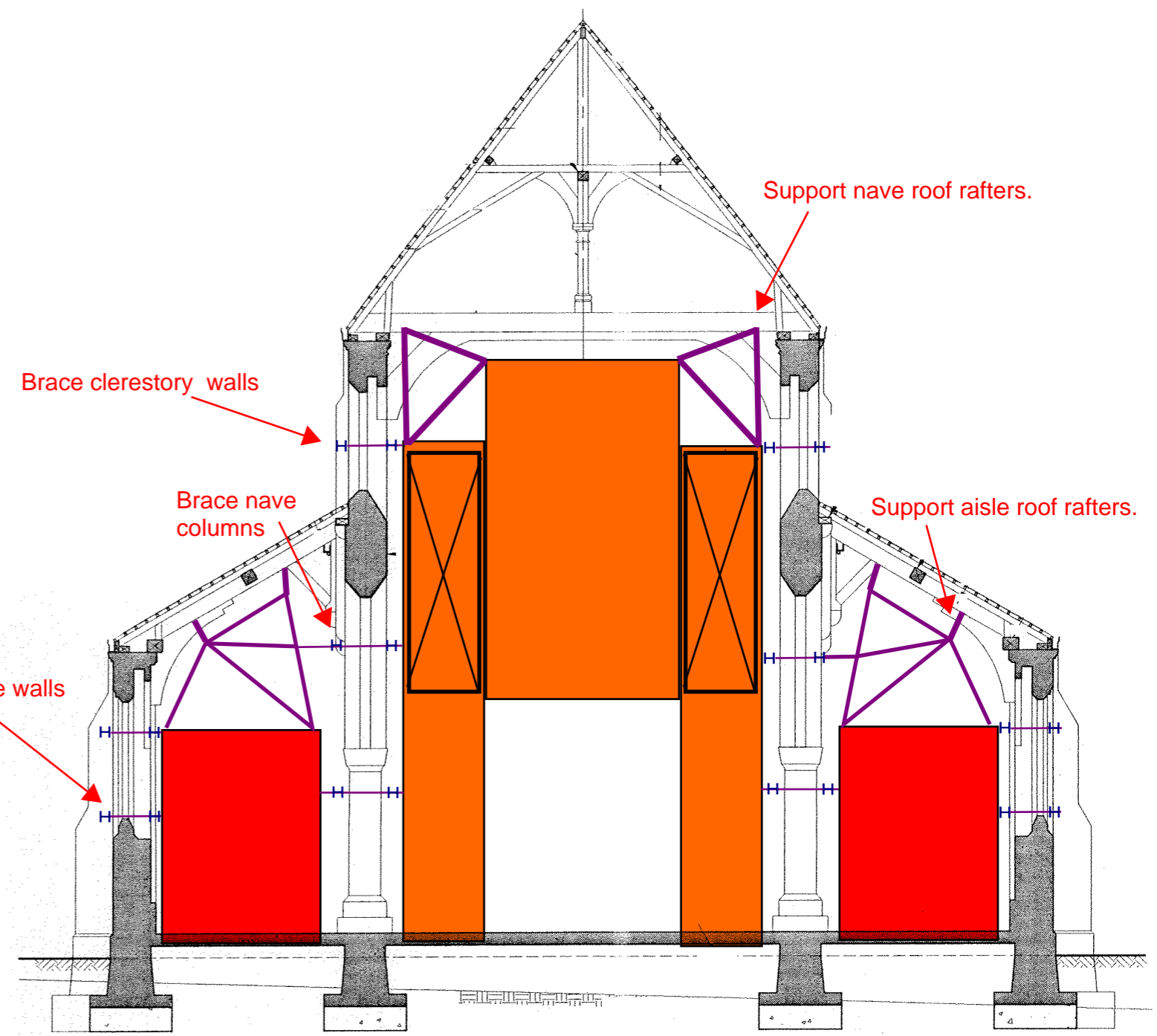
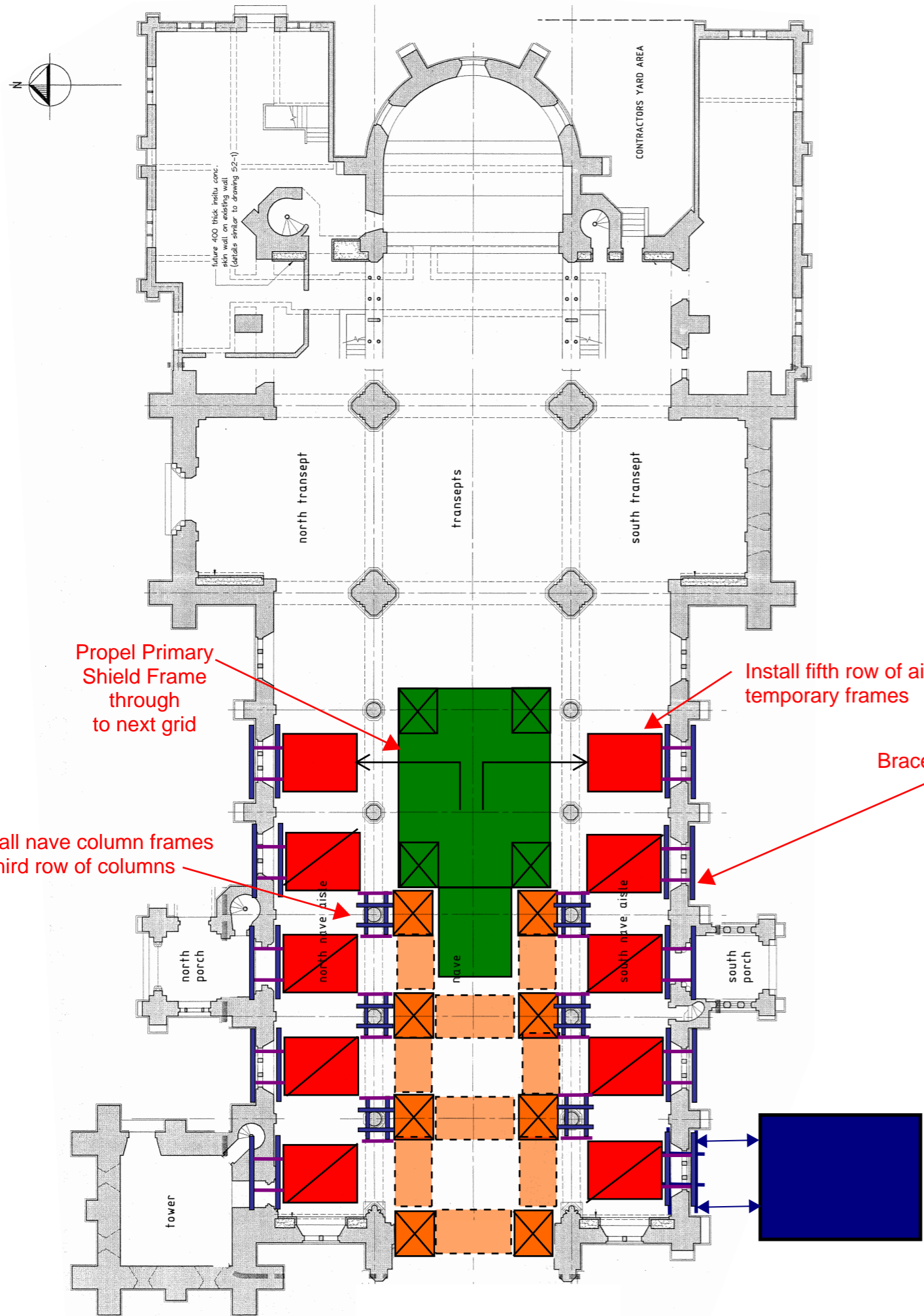

**CHRISTCHURCH CATHEDRAL**  
 MAXIMUM RETENTION OPTION  
 STAGE 6